

R a s e      h i l l

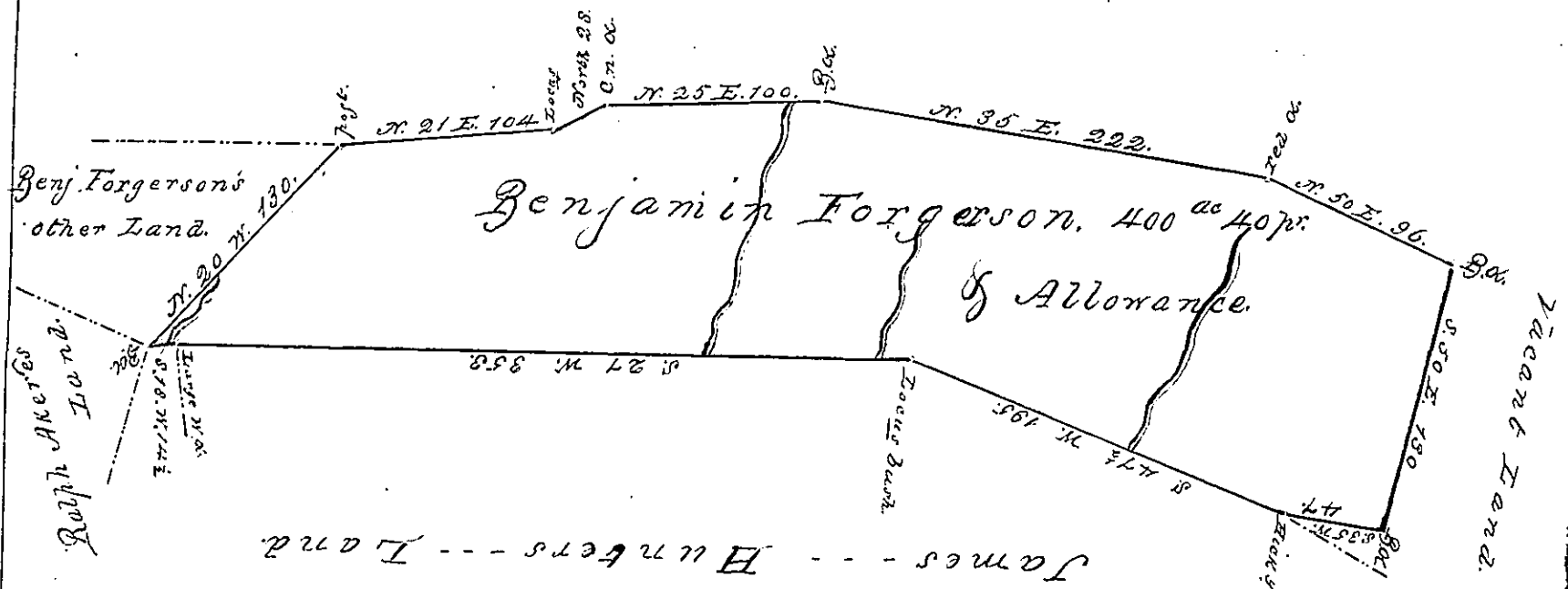

Situated on the waters of Brush Creek in Providence Township Bedford County containing Four Hundred Acres and forty perches with the usual allowance of six per cent for Roads &c. Surveyed for Benjamin Forgerson the Twenty third day of September 1796. In Pursuance of a Warrant dated October 13<sup>th</sup> 1795-

Wm. Brockhead Esq. Sg.      George Woods Junr. S.D.

IN TESTIMONY that the above is a copy of the original remaining on file in the Department of Internal Affairs of Pennsylvania, made conformably to an Act of Assembly approved the 16th day of February, 1833, I have hereunto set my Hand and caused the Seal of said Department to be affixed at Harrisburg, this

Tenth day of July 1876

Wm. Standley  
Secretary of Internal Affairs